

Lancaster Conferences



“ A huge thank you to the team at Lancaster! We had a great conference and the entire team at the University were really helpful. Steven and Jamie were a pleasure to work with. The food was the best we've ever had at a conference and we got lots of positive comments from delegates about it. Your good humour, attention to detail, personal service and very hands-on presence was what really made the difference to us.

I work at the University of Leicester in a building which houses two other subject associations and we've already recommended Lancaster Conferences to both of them. I am sure that ALL will consider Lancaster as a venue in the future. ”

Linda Parker, Director, Association for Language Learning

“ We come back each year as the relationship and organisation offered by Lancaster Conferences means that I don't have to worry about a thing.

Everything runs like clockwork and I know that the team will manage the event appropriately. In addition, the catering, bedrooms and AV support is excellent. ”

Catriona Curtis, The Society of Practising Veterinary Surgeons (SPVS)

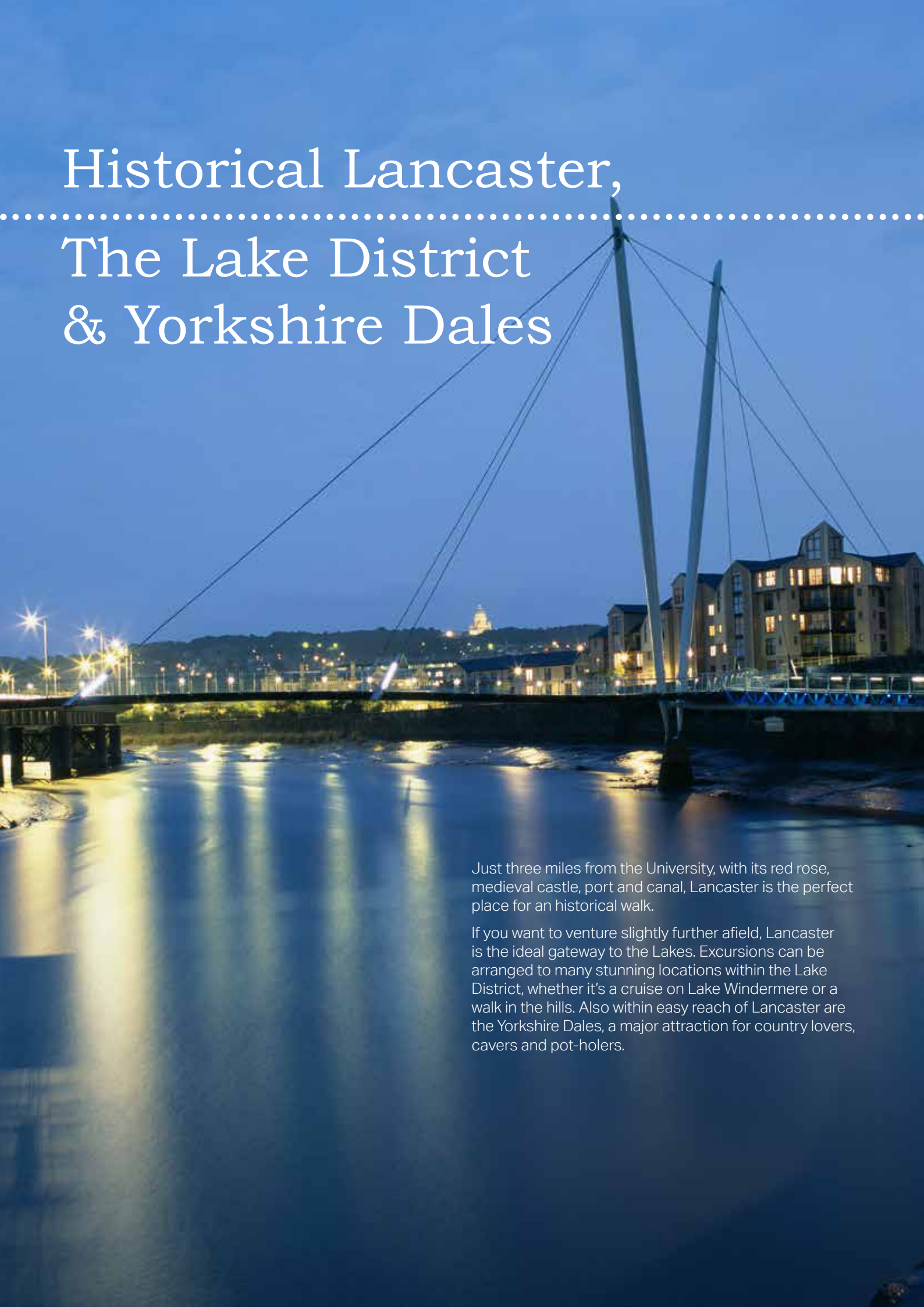

Historical Lancaster, The Lake District & Yorkshire Dales

Just three miles from the University, with its red rose, medieval castle, port and canal, Lancaster is the perfect place for an historical walk.

If you want to venture slightly further afield, Lancaster is the ideal gateway to the Lakes. Excursions can be arranged to many stunning locations within the Lake District, whether it's a cruise on Lake Windermere or a walk in the hills. Also within easy reach of Lancaster are the Yorkshire Dales, a major attraction for country lovers, cavers and pot-holers.

An International Reputation

In international league tables, Lancaster consistently ranks in the top 1% of universities. The University is an outstanding academic institution with an international reputation for its facilities.

With its exceptional facilities in mind, Lancaster is the perfect place to host a truly spectacular conference or event.

Lancaster Conferences offer an extensive selection of versatile meeting spaces to meet your needs all year round.

All packages include everything you will require from complimentary Wi-Fi, locally-sourced food and refreshments, a dedicated event manager, as well as spaces set up as requested.





A Modern Campus

The University has invested £450 million into the campus over the last ten years, with a further £135 million planned over the next 3 years, creating new academic facilities and great teaching, meeting, residential and social spaces including a £20m Sports Centre.

To ensure your conference runs smoothly and successfully, all of our meeting spaces are fully equipped with audio-visual equipment and Wi-Fi. You can make use of our free mobile app, iLancaster which provides a directory of services and information.

Bespoke versions of iLancaster are produced so that conference delegates can check their conference timetable, locate buildings on campus, see their accommodation and parking information and check the weather forecast.

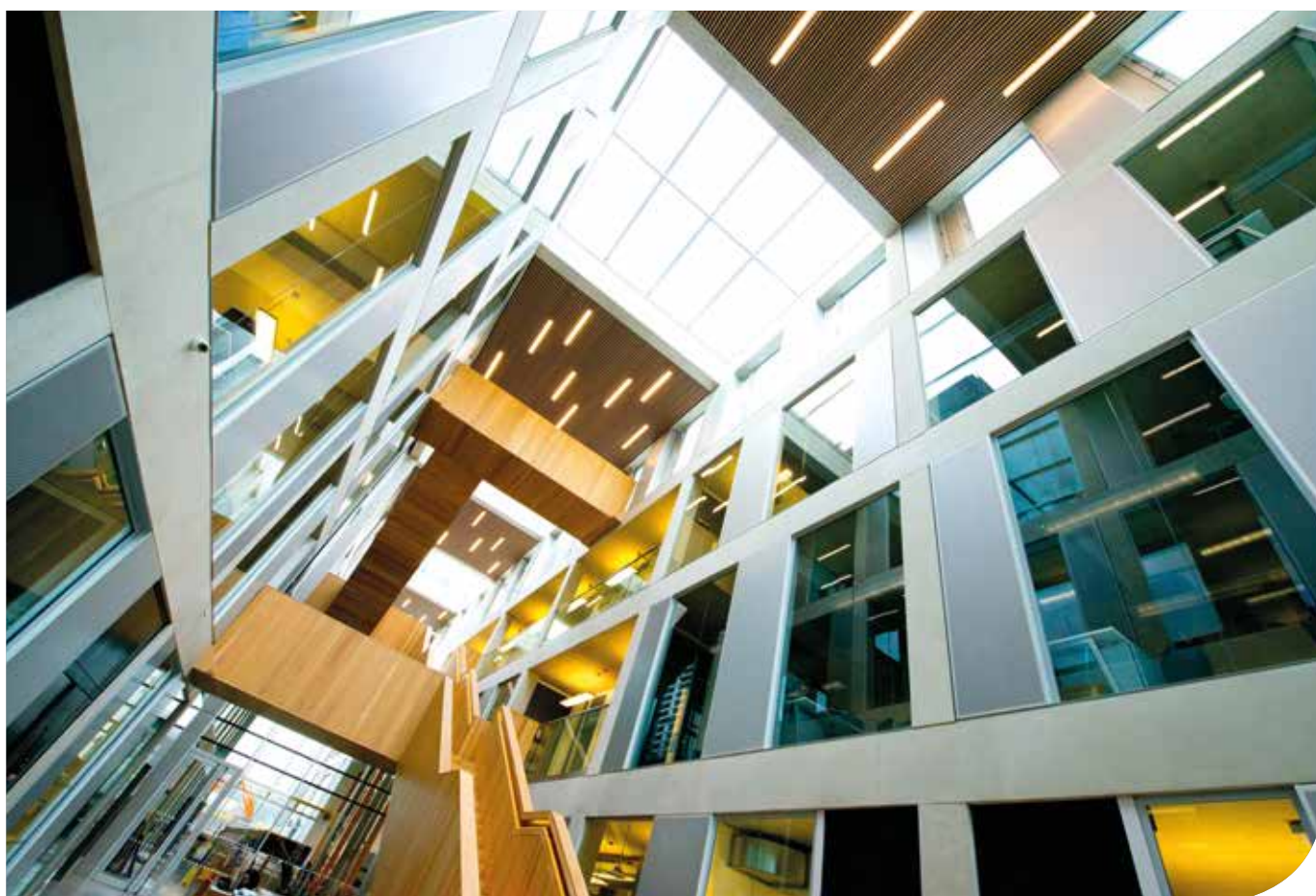

The Heart of Campus

Lancaster University is situated in 360 acres of beautiful parkland which has been awarded the Green Flag, a national accreditation for high quality green space, for three years running. Our conference and meeting spaces are located in the heart of the campus.

We can accommodate up to 1000 residential delegates and our meeting spaces include spacious foyers, perfect for exhibitions and room to network, lecture theatres and meeting rooms.

Our Executive Chef and his team deliver Food for Life award winning meals and refreshments ensuring ingredients are fresh, healthy and locally-sourced. We will meet your needs whether it is morning coffee and cakes or a formal annual dinner.

The campus is an intimate and vibrant town in its own right with 9 college bars, 2 banks, a post office, 2 convenience stores and over 20 other shops, cafes and restaurants.

The University is brimming with culture; it boasts its own theatre, art gallery and concert series. The Nuffield Theatre is one of the largest professional studio theatres in Europe. There is also a multi-faith Chaplaincy Centre and a Muslim prayer room.

www.lancaster.ac.uk/conferences



County College



County College is situated at the north of the campus where there are many facilities including our three star accredited accommodation.

We have 176 en-suite bedrooms available as both single or twin rooms. Complimentary Wi-Fi is supplied and free parking is conveniently located by your accommodation.

We can provide catering for up to 550 delegates in a variety of venues situated in the college and there are many opportunities to enjoy local Lancashire produce as we work closely with local businesses who provide fresh and seasonal ingredients.





Cartmel College

Our accommodation in Cartmel College, Alexandra Park, has capacity for up to 800 delegates. It provides award-winning en-suite bedrooms complete with complimentary internet access.

Cartmel College is noted for its tranquillity, beauty and stunning views of the countryside and is steeped in history, boasting a seventeenth century cottage known as Barker House Farm.

We offer catering at Barker House Farm, with quality, locally-sourced food and a friendly atmosphere; as well as serving a fantastic selection of drinks at the bar.





LICA

The £10m LICA building is the greenest building on any UK campus achieving BREEAM outstanding. Completed in 2011, this inspiring purpose built venue accommodates conferences of up to 800 delegates and is a great exhibition venue or meeting area.

The bright, double height open plan space can be divided into three equal sections or used as one large space accommodating up to 350 delegates in a cabaret layout, making the venue entirely flexible for your event.

There are also an additional four classroom breakout spaces with seating for up to sixteen people.

The LICA building and our larger spaces, such as the Great Hall and George Fox Complex, are available during the University's vacation periods.

These periods usually fall in April, July, August and September. Please contact us for more details.





The Great Hall

The Great Hall, situated towards the north of the campus, has held many historic events over the years for Lancaster University.

Accommodating up to 800 delegates, the versatile hall can be utilised as meeting, exhibition or refreshment space.

We also have 1,000 en-suite bed and breakfast bedrooms within a five minute walk of The Great Hall making it the perfect location for gala dinners for up to 320 guests.



Other Large Spaces

George Fox Complex

The George Fox Complex offers the largest lecture theatre on campus holding 350 delegates. Five other rooms, which accommodate 45 delegates in a cabaret layout, surround a central foyer which is ideal for exhibitions.

Management School

The Management School comprises numerous lecture theatres, six meeting rooms and substantial social and breakout areas. Its largest lecture theatre holds 150 delegates and there is a further eleven various sized lecture theatres with both flat and tiered layouts.

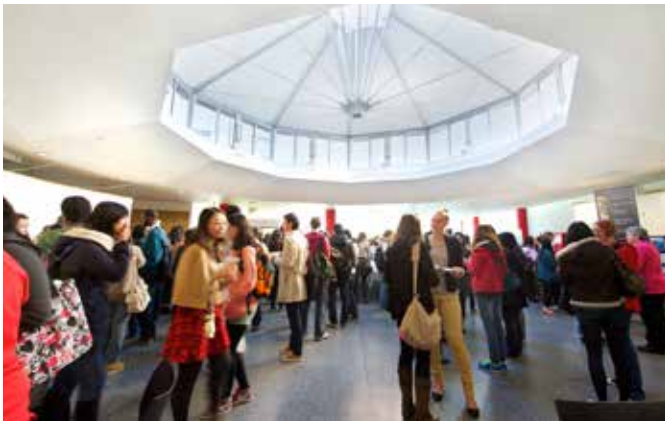

Green Lane

Within walking distance of all the key meeting spaces, Green Lane offers 16 purpose-built meeting rooms accommodating up to 100 delegates.

There are three large training suites each with adjoining syndicate rooms which surround a bright and comfortable lounge area.

Adjacent to Green Lane is the Lancaster House Hotel which offers a selection of four star luxury suites.

Twin and double rooms are available with the opportunity to use the leisure facilities. Why not indulge in one of the many treatments available in the beauty salon during your free time.





On your doorstep

Whilst modern and connected with all the facilities you need during your meeting, conference or event, Lancaster is also a campus where you can enjoy your leisure time.

Take advantage of our state of the art Sports Centre and use the 25 metre swimming pool, gym or scale the climbing wall. Relax and experience peace and tranquillity on our woodland walk or simply sit by the pond and enjoy the parkland.

The campus also has a great café culture during the day and nine college bars to choose from in the evenings as well as an art gallery, theatre and concert series.

www.lancaster.ac.uk/sportscentre
www.liveatlica.org



How to find us

Our vast greenfield site offers wonderful views of mountains and sea, yet the campus is just a 5 minute drive from the M6 motorway and ten minutes from the main West Coast railway with direct services to Manchester, Leeds, London and Scotland.

By Road

Leave the M6 motorway at junction 33 and take the A6 towards Lancaster. Pass through Galgate village and after 1.5 miles at the second set of traffic lights, turn right up the main University drive.

By Train

There are direct rail links between Lancaster and London, Birmingham, Leeds, Manchester, Oxford and major cities in Scotland.

By Air

From Manchester International airport, take the M56 motorway at junction 5 and join the M6 motorway at junction 20a (north to Preston and Lancaster). Follow the directions in the 'By Road' section. A direct rail link runs between Manchester airport and Lancaster.

By Bus/Bike

We have a dedicated University bus service and a traffic-free cycle route linking the campus to the outskirts of the city.
www.stagecoach.com

More information is available at
www.lancaster.ac.uk/conferences

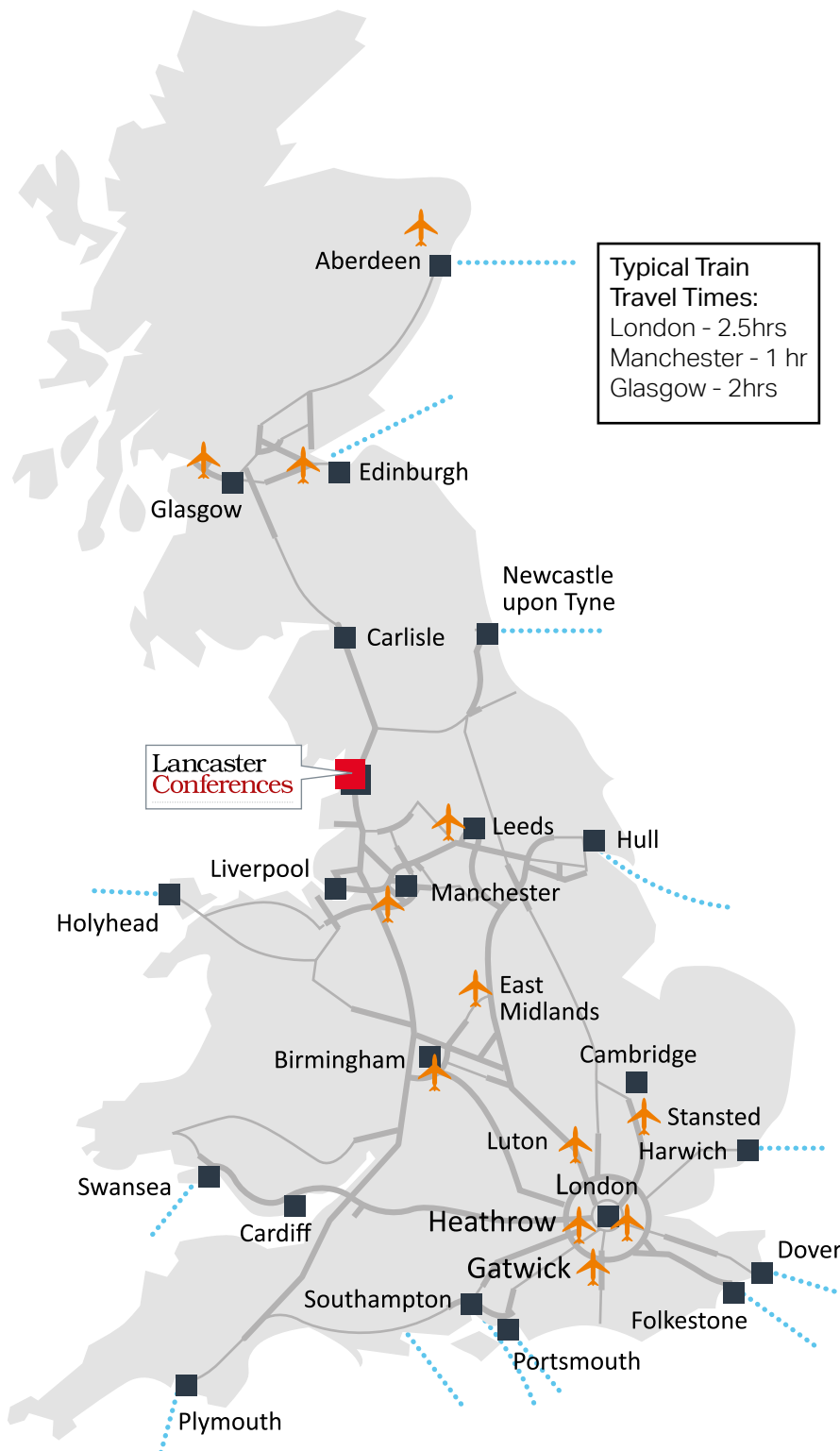

A warm welcome awaits you at Lancaster Conferences. Our experienced, customer focused team are here to remove the stress and strain of organising your conference, offering tailor made packages to suit your needs.

Get In Touch

Email: lancasterconferences@lancaster.ac.uk
Tel: 01524 592444

www.lancaster.ac.uk/conferences
 [@EventsLancaster](https://twitter.com/EventsLancaster)

